

EASTSIDE MEMORAL PARK

Katia Astudillo, Abdu Kort, Lindsey Louisma, Ismael Vela

This project is an attempt to reintroduce Eastside’s relationship to nature in an urban context. Although Eastside has an abundance of natural elements it’s identity has been primarily tied to the steel mills. In the Eastside Memorial Park we’ve added a literal green strip that hosts the memorial’s “Trees of Life” juxtaposed to a representational supergraphic of nature and representational elements such as, tree lights, to engulf the site in its natural context.

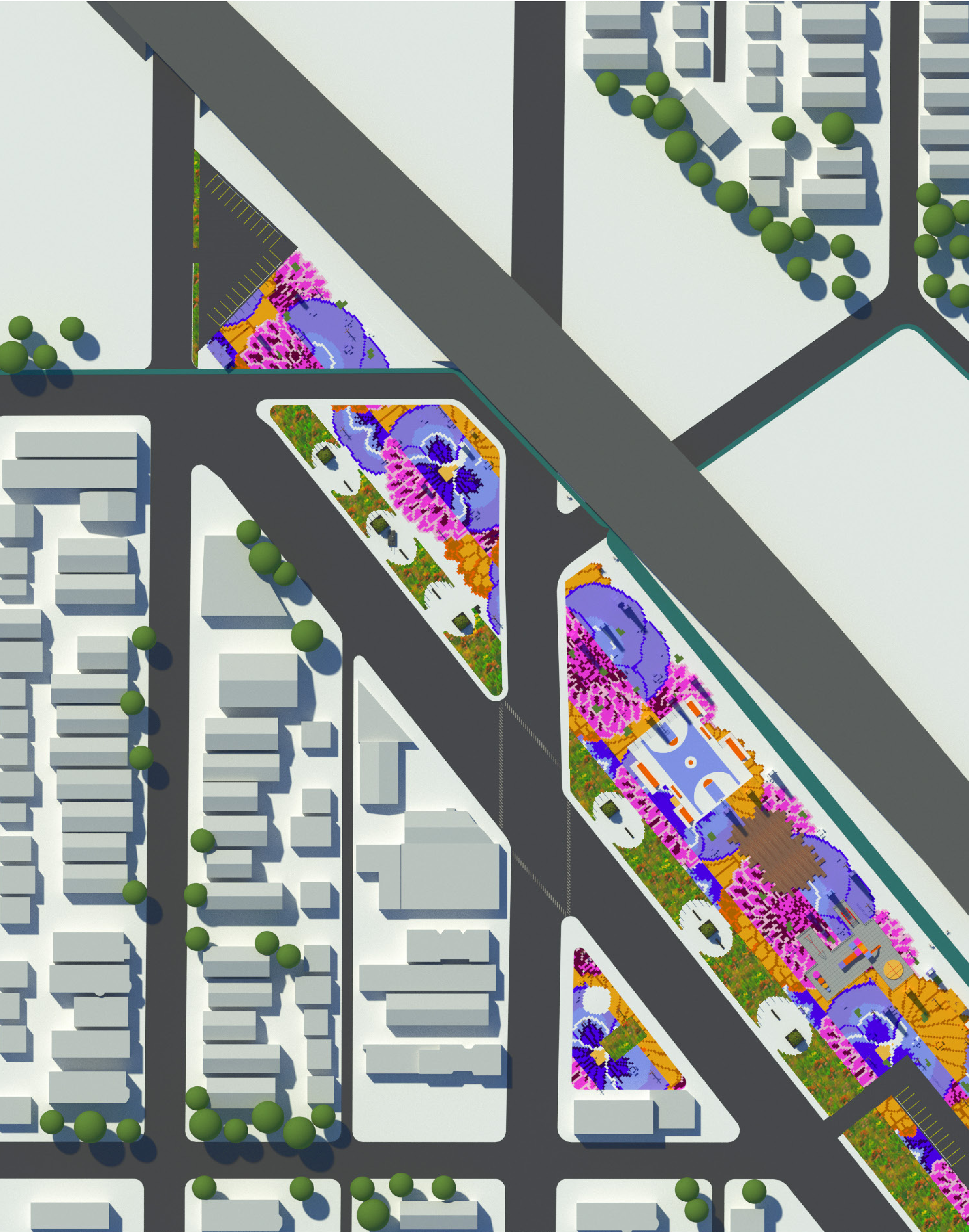

Basketball Court

The basketball court is meant to be an exercise space within the park.



Stage

The stage is meant to accomodate external events and community events.



Playground

The playground is the kids designated space within the park.

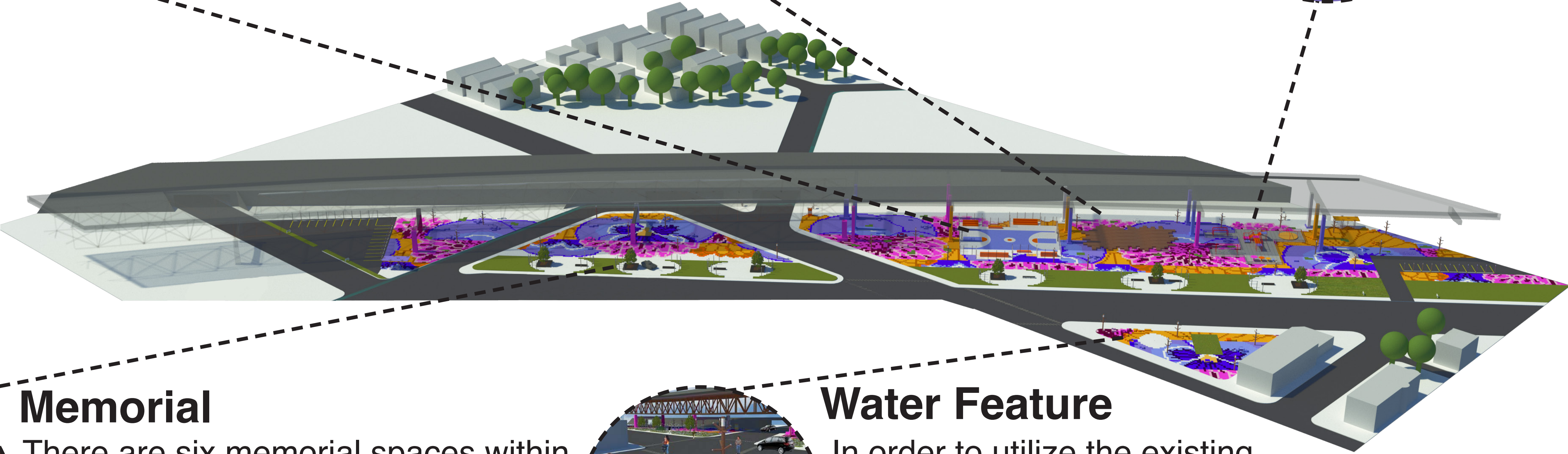

Memorial

There are six memorial spaces within the park which are meant to be intimate and represent a different war where lives have been lost.



Water Feature

In order to utilize the existing plumming system and make it interactive we have added a puddle that people can play in.

